

**DAVIS ELEMENTARY SCHOOL
ATHLETIC COMPLEX**

415 S. Providence Road 10 Acres

Richmond, VA 23236

Shelter Reservation: 751-4696

Program Registration: 748-1623

Field Reservations: 751-4199

Magisterial District - Midlothian

GIP No. 760703489900000

Park Maintenance: 748-1624

www.chesterfield.gov

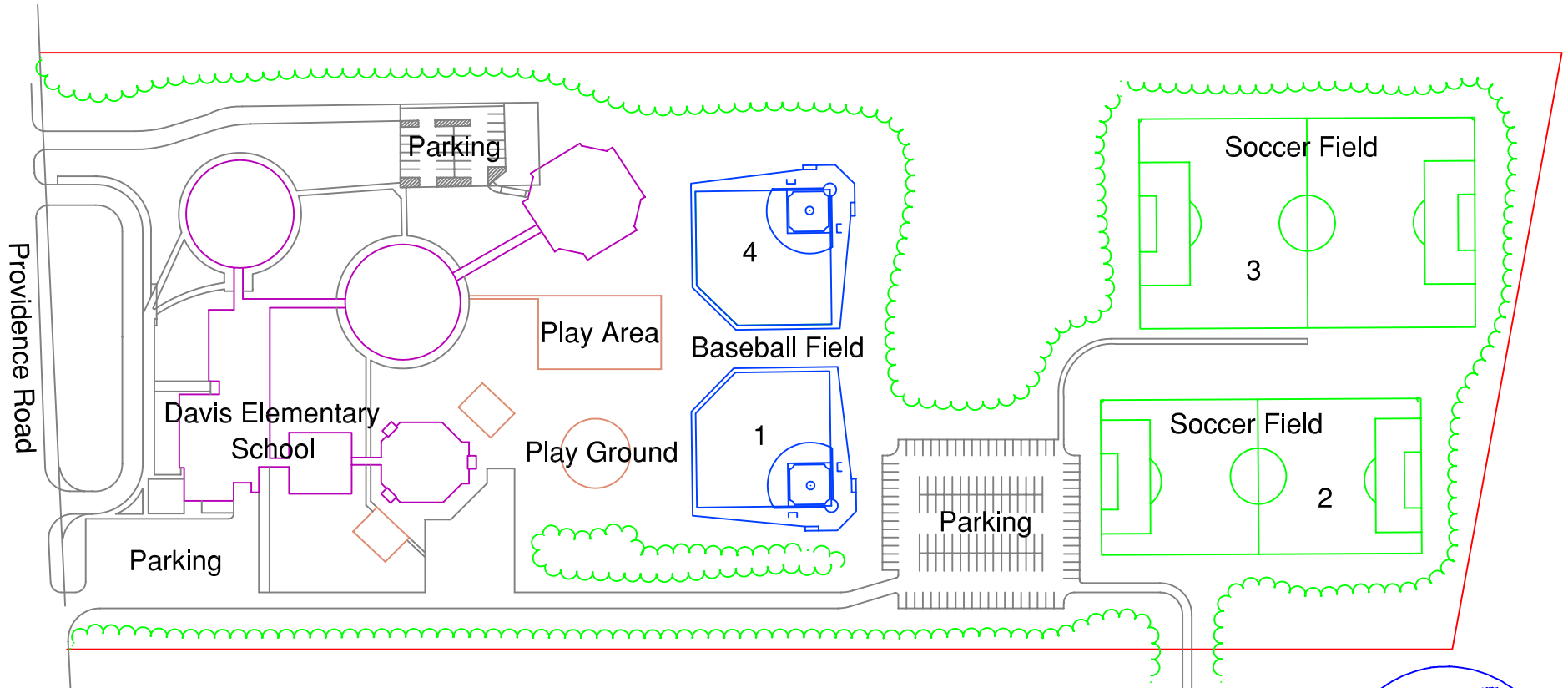

Scale



To Providence
Athletic Complex



Date 8/1/05